



Sturtevant Richmond

3203 N. Wolf Road Franklin Park, IL 60131

Phones: 847/455-8677 800/877-1347 Fax: 847/455-0347

E-mail: CustomerService@srtorque.com

Web: www.srtorque.com

Rundown Fixtures Instruction Sheet

Applicable Products	
Part No.	Model
10294	Rundown Fixture 80/150
10295	Rundown Fixture 250
10355	Rundown Fixture 68 Nm
10356	Rundown Fixture 109 Nm
10357	Rundown Fixture 204 Nm
10358	Rundown Fixture 339 Nm

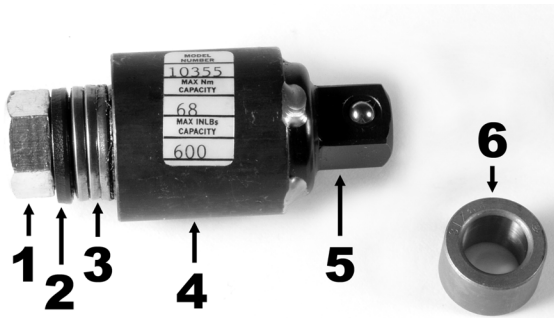

Photo Key:

- Grade 8 Bolt (English)/Class 10.9 Bolt (Metric)
- Flat Washer, 1 per fixture, spreads load from bolt over face of top Belleville Washer.
- Belleville Washers, 4 per fixture, lubricated with molybdenum disulfide grease, sets joint rate.
- Body, houses internal components.
- Male Drive Square, inserts into tester female drive square.
- Bushing, used to emulate hard joint reaction (10355 and 10358 only).

To Use Fixture:

- Unscrew Bolt to last thread.
- Insert Male Drive Square of fixture into female drive square of tester. Use drive square adapter if required.
- Configure tester for power tool test per tester instructions.
- Configure power tool for testing per power tool instructions.
- Engage socket securely to bolt hex.
- Perform test; run bolt down fully into fixture until it stops moving or power tool shuts off.

Fixture Maintenance:

- Check bolt hex and thread condition after every set of tests. Replace bolt if threads or hex are damaged.
- Check lubricant before each set of tests. Lubricant must be present on Belleville Washers, under bolt head, and on bolt threads and must be clean (free of contaminants).
- Disassemble fixture, clean lubricant off components, and replace with new lubricant every 3,000 rundowns or when lubricant becomes contaminated, whichever occurs first.
- Visually inspect washers for cracks or chips each time fixture is disassembled. Replace any cracked or chipped washer immediately - before next use of fixture.

Safety:

Always wear all recommended safety equipment when operating power tools.

Questions and Parts:

If you have any questions or need to order parts for your rundown fixture, please contact S/R using the contact information at the top of this instruction sheet. Part numbers are below.

Part Numbers

Component	80/150 10294	250 10295	68 Nm 10355	109 Nm 10356	204 Nm 10357	339 Nm 10358
Bolt	30331	30332	890859	890854	890863	890864
Bolt Size/Class	5/8"-18 UNF 2A Grade 8 1.75" Shank	7/8"-14 UNF2A Grade 8 2.5" Shank	M12 x 1.75 Class 12.9 30mm Shank	M14 x 2.0 Class 10.9 35mm Shank	M16 x 2.0 Class 12.9 40mm Shank	M20 x 2.5 Class 12.9 40mm Shank
Flat Washer [hardened]	20861	30417	891025	891031	891050	891052
Belleville Washer	30415	30416	891024	891030	30415	891055
Fixture Body	21216	21217	811395	811396	811397	811398
Bushing	None	None	891026	891032	891051	891053