



Sturtevant Richmond

Global Reach. Local Support.

3203 N. Wolf Road
Franklin Park, IL 60131
Phones: 847/455-8677 800/877-1347
Fax: 847/455-0347
E-mail: CustomerService@sr torque.com
URL: www.srtorque.com

Service Instructions

Part No.

810275
810276

Model

SLTCFM-3600I Preset Interchangeable Head Torque Wrench
SLTCFM-4800I Preset Interchangeable Head Torque Wrench



Equipment Required: Phillips Screwdriver (#1), CART Tool, Torque Tester

To Adjust Torque

- 1) Attach SD- or SDRT-Series Interchangeable Head to Dovetail Connector on wrench.
- 2) Test wrench on torque tester to determine current torque setting.
- 3) Remove rubber Grip Cap.
- 4) Insert longest hex of CART Tool into innermost internal hex nut (Torque Adjustment Nut) inside Grip.
- 5) Insert shorter hex of CART Tool into outermost internal hex nut (Lock Nut) inside Grip.
- 6) Hold T-handle of CART Tool still, and rotate outer hex key counter-clockwise about 90° to unlock Lock Nut from Torque Adjustment Nut. Lock Nut operates by acting like a jam nut – jamming against the Torque Adjustment Nut to prevent rotation and torque setting change.
- 7) Use T-handle of CART Tool to adjust torque by rotating Torque Adjustment Nut.
 - a) Turn CART Tool clockwise to increase torque setting.
 - b) Turn CART Tool counter-clockwise to decrease torque setting.
 - c) Make adjustments to torque setting in small increments; use less than 180° of rotation between tests.
- 8) Once adjustment is made, retest tool on torque tester.
 - a) If desired torque setting has not been attained, return to Step 7 of this procedure.
 - b) If desired torque setting has been attained:
 - i) Hold CART Tool T-handle steady to prevent rotation of the Torque Adjustment Nut.
 - ii) Use outer hex key to engage Lock Nut and rotate clockwise until it firmly engages Torque Adjustment Nut.

Electronics/Transmitter Components

The battery and electronics for the transmitter are housed in the black plastic compartment located just in front of the tool grip. This compartment must be opened to change the battery, set or change the channel used for FM radio communications, or to replace the circuit board if necessary.

The case has two parts. The bottom is permanently attached to the wrench; the top is removable. To remove the top, first loosen completely the four #1 Philips head screws highlighted in the photograph to the right. Then lift the top of the case straight up off the bottom of the case.



Photo Key

- 1. Screw Holes (4)
- 2. Isolation Paper
- 3. Battery Recess
- 4. Screws, Philips Head #1
- 5. Channel Selection Jumpers (3)
- 6. Microswitch Activation Lever
- 7. Battery, 12V, "N" size
- 8. Battery Holder
- 9. Microswitch Activation Pin

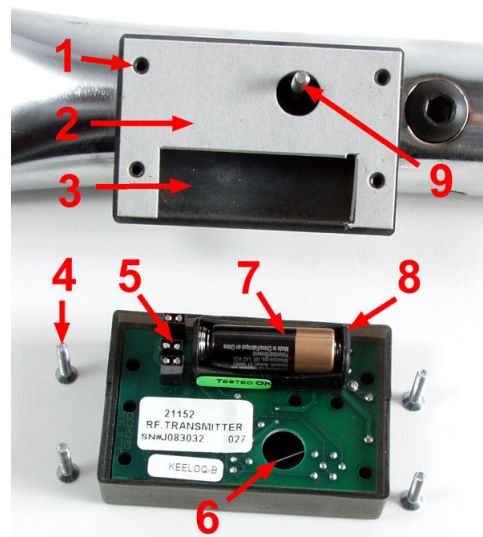

FM Transmission Channel Selection

Transmitter channel selection is performed via the insertion or removal of the Channel Selection Jumpers. The jumpers are mounted on pins, and connect the pins electrically.

The three jumpers are numbered 1, 2, and 3, from the inside towards the outside of the case. Each Jumper is removed by gently gripping it then pulling it up off the board until it disengages the pins beneath. To install jumper, align it with the pin pair and gently push down until it seats against the board.

To set the FM Transmission Channel, use the table below.

Channel	Jumper #1	Jumper #2	Jumper #3
0	Installed	Installed	Installed
1	Installed	Installed	Not Installed
2	Installed	Not Installed	Installed
3	Installed	Not Installed	Not Installed
4	Not Installed	Installed	Installed
5	Not Installed	Installed	Not Installed
6	Not Installed	Not Installed	Installed
7	Not Installed	Not Installed	Not Installed

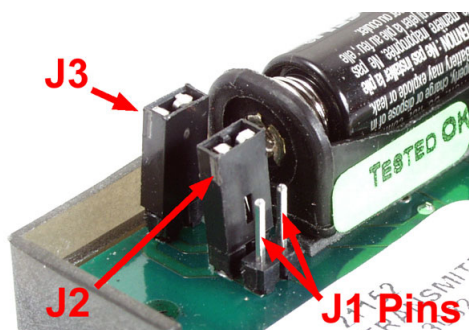

Battery Replacement

With top of Electronics Compartment inverted as shown, gently remove Battery (7) from Battery Holder (8). Insert new Battery into Battery Holder, maintaining same orientation (polarity).

Reassembly of Electronics Compartment.

Carefully align top of compartment directly over bottom of compartment. Lower top gently onto bottom and insert all four Philips head screws. Use #1 Philips head screwdriver to tighten screws until snug. Do not overtighten.

Hand Tool Safety

- Always use recommended safety equipment when working with hand tools.**
- Do not use the hand tool beyond its' rated capacity.**
- Do not use any hand tool for a purpose for which it was not intended.**

Cleaning

Clean outside of wrench with a damp cloth. Do not immerse tool in cleaning fluid or other liquids.

Warranty

For details of warranty, see Sturtevant Richmond catalog or visit our website: www.srtorque.com

Additional Information

An expanded version of the torque setting procedure, and other procedures pertinent to this and other S/R products, may be found in the FAQ section of our website: www.srtorque.com. Additional information may also be obtained from your distributor or Sturtevant Richmond representative, or by contacting us by phone, e-mail, or fax. Our contact information is given on the front of this document.